

国际新建筑

August 2012

10

INA

International New Architecture

International New Architecture

国际新建筑

August 2012

Volume 1

江苏人民出版社

江苏人民出版社

Feature 专题
Building Roof
建筑屋顶

“艺术家之声：城市景观”展馆里的特色玻璃作品——泰格亚派特1994年的作品“螺旋”
Voices of the Artist: The Cityscape with featured glass work Spirale, 1994, Lino Tagliapietra.

Corning **Museum of Glass**

玻璃艺术轨迹——康宁博物馆玻璃展览

| HAIGH Architects |



“当代玻璃之声”入口大厅的图示墙和戴尔·奇胡利1999年的作品“橙色茜草器皿上的首弟慵懒地躺在蟹身上”。
Voices of Contemporary Glass: Introduction lounge Graphic Wall with featured glass work Putti Lounging on Crab Resting on Orange Madder Vessel, 1999, Dale Chihuly.

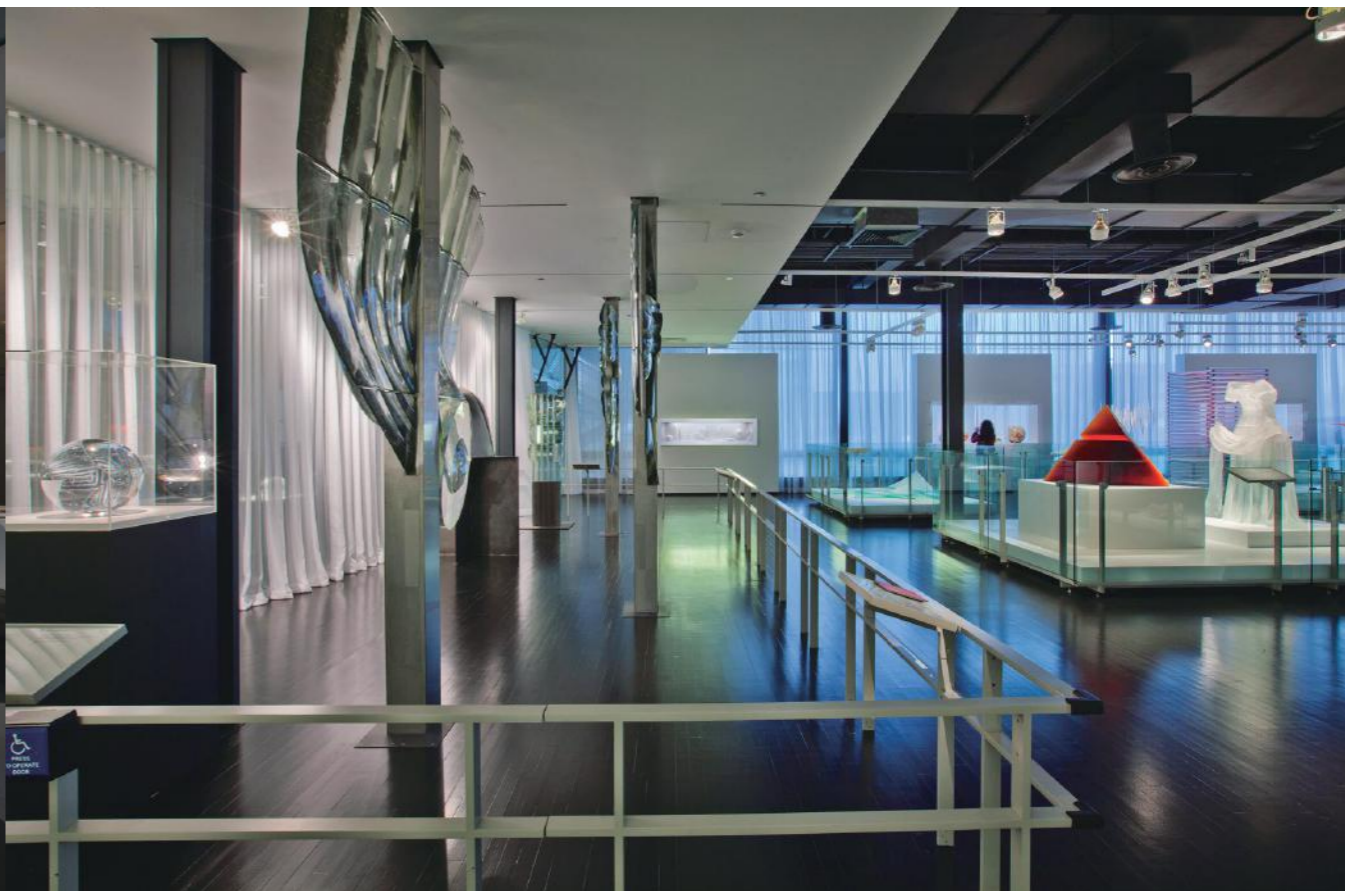

斯坦尼斯拉夫·李本斯基和亚罗斯拉娃·布克托娃的当代雕塑作品。
Contemporary Sculpture enclosure of works by Stanislav Libenský and Jaroslava Brychtová.

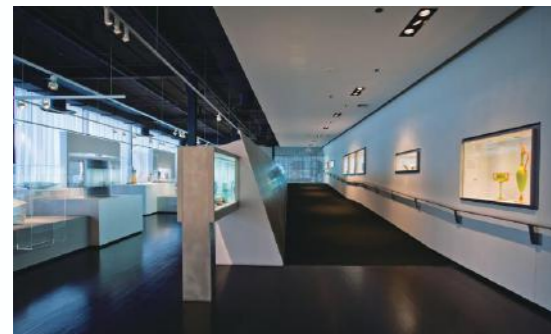

“玻璃景观”当代雕塑长廊和橱窗斜坡。
Contemporary Sculpture “GlassScape” Gallery and Vitrine Ramp.

过929平方米的开放式当代雕塑展馆。
通过一系列用于展示的建筑元素，这些艺术作品按照不同的艺术家来分类，而不是艺术主题、日期或工艺。这些装置邀请游客通过不同大小的空间来进入一段探索国际工作室玻璃艺术历史环境的旅途。
这些玻璃艺术作品被独立放置在定制的玻璃橱窗里，保持良好的可见度和一种私密性。墙壁上分散的空间等设计元素相互作用，构成的图形展示了其类型学和工艺步骤。一系列大型的“家具”元素提供了连续的展示表面，配合艺术家作品提供观赏区域。

“艺术家之声”展馆的特色艺术家之墙。
Voices of the Artist: Featured Artists Wall.

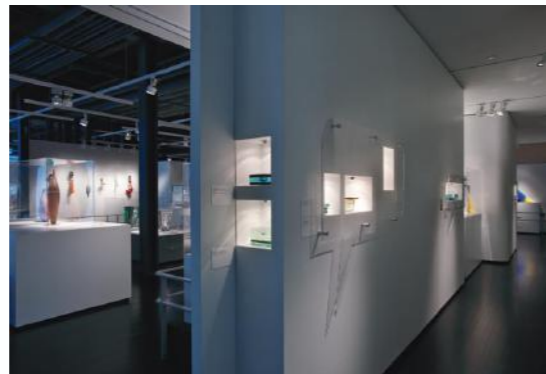

博物馆的展厅展出了近25年国际艺术家制作的当代玻璃器皿、物品、雕塑和装置。这个展出意在显示玻璃的不同用途和作为当代艺术的媒介。这个展厅以海涅曼家族命名，他们在2005年捐赠了博物馆的一件主要当代玻璃藏品。
大型的作品与较小的物品和非功能性的器皿展示了丰富多样的玻璃工艺，包括吹制、铸造、密封、烘烤、锻压、着色、卷边和装配。展厅里的每一件展品都是独一无二的，而不是限量版或大批量生产的产品。
这个展览覆盖了美国工作室玻璃艺术的发展历程，包括87位艺术家的240件作品，创作于1969年至2005年之间。为了这次展览，需要翻新和扩建超

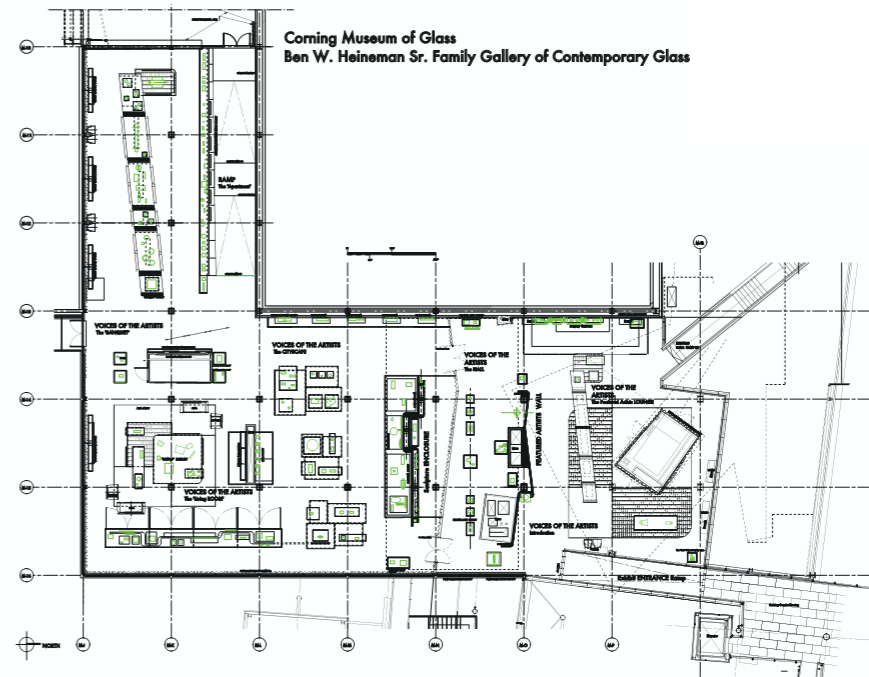



“诗丹兰雅”当代玻璃雕塑柱。
Contemporary Glass "Stellae" Sculpture podium.



雕塑柱上的特色玻璃作品——西尔维娅·莱万森1996-2004年的作品“雨刀”和金子润2001年的作品“玻璃棍”。
Contemporary Sculpture podium with featured glass works It's Raining Knives, 1996-2004, Silvia Levenson and Glass Sticks, 2001, Jun Kaneko.



“艺术家之声”展馆里的“玻璃盛宴”长廊。
Voices of the Artist: The "Glass Banquet" Gallery.

当代雕塑橱窗斜坡北墙。
North Wall Contemporary Sculpture Vitrine Ramp.



The museum's gallery of contemporary glass focuses on vessels, objects, sculptures, and installations made by international artists over the last 25 years. The purpose of the gallery is to show the different ways in which glass is used as a medium for contemporary art. The gallery is named for the Heineman family, who donated a major collection of contemporary glass to the Museum in 2005. Large-scale work is complemented by smaller-scale objects and nonfunctional vessels in a variety of glassworking techniques, including blowing, casting, kiln forming, flameworking, laminating, stained glass, beading, and assemblage. The gallery features unique objects, rather than limited-edition or mass-produced products. The exhibition, covering the chronology of the American Studio Glass art movement, includes 240 objects by 87 artists, made between 1969 and 2005. The design program called for exhibition design and architectural design to renovate and expand over 929m² of the open plan contemporary sculpture galleries.

Exhibited in a series of architectural narratives, the art works are presented by artist, rather than by artistic theme, date, or technique. The installation invites the visitor on a journey, through multiple scaled spaces, to explore the historical context of international studio glass art. Glass art works are displayed throughout in custom designed "vitrine" cabinetry scaled individually to encourage viewing and a sense of intimacy. Architectural wall display elements, designed to present the interactive and graphic media, form discrete spatial divisions linking typologies and technical process. A series of large scaled "furniture" elements provide continuous surfaces for display, seated viewing areas and featured artist presentations.

“什么是玻璃”录像装置。
"What is...Glass" video installation.



泰格亚派特2004年的当代雕塑装置“竭尽全力”。
Contemporary Sculpture installation featuring "Endeavour", 2004, Lino Tagliapietra.



Credits

Architects and Exhibition Designers: Paul Haigh and Barbara H. Haigh, HAIGH Architects
Curator: Tina Oldknow
Graphic Design: Luckystone Partners, HAIGH Architects
Installation Photography: The Corning Museum of Glass
Nick L. Williams, Andrew M. Fortune
Video Installation: Bruce Blackburn